

EQ6

HAND-HELD VACUUM CLEANER

INSTRUCTION MANUAL

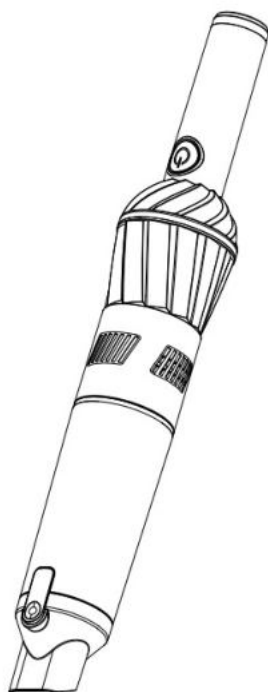

TT-EQ6

www.zline-world.com



Thank you for choosing **EQ6** Powerful and portable Hand-Hold Vacuum by **TurboTronic®**.

EQ6 Handheld Vacuum makes it easy to pick up messes quickly without the hassle of cords. This 11.1V Lithium incorporates lithium technology for strong suction. The lightweight and portable design makes this handheld vacuum easy to use. The translucent, bagless dirt bowl makes it easy to see the dirt level and is simple to empty.

Cordless and lightweight design helps you to fully enjoy movement freedom and easy clean-up wherever you go.

EQ6 cleans even the tougher areas such as stairs, Upholstery, Furniture, Cars, Liquids and more.

SPECIFICATION

Brand:	TurboTronic®
Model:	TT-EQ6
Rated voltage:	220-240V/ 50/60Hz
Power:	85W, 11.1V
Capacity:	0.28L

WARNING:

Please take care of the instruction for future use.

- Children must be supervised by an adult. Do not allow children to play with the vacuum cleaner
- This appliance is for family use only. Do not use outdoors
- When unplugging the charger, please hold the plug, do not pull the power cord
- Do not leave the vacuum cleaner when the power is on, so as not to cause harm

- If the power cord is damaged, it must be replaced by a maintenance worker. Do not replace without permission, so as not to cause harm
- The following objects are strictly prohibited, otherwise it will damage the vacuum cleaner or cause fire, causing harm to human body.
- Do not absorb large or sharp objects, such as glass
- Do not absorb reactive liquids (e.g., soluble, corrosive, detergent, etc..)
- Do not absorb flammable or explosive objects, such as gasoline, alcohol...
- Always check equipment or charger for damage.
- If there is any damage to the airframe or other places, please do not continue to use. Do not open the device or charger without permission, and do not replace the power cord by yourself. Please send the machine to professional maintenance personnel for maintenance. Do not try to repair the machine by yourself to avoid injury
- Please pay special attention not to trip the power cord when charging the machine
- Keep power lines away from hot surfaces. (e.g., cooking utensils and other hot objects).
- Do not touch the charger or power cord with damp hands.
- When using a vacuum cleaner, do not aim the cleaner at people or animals.
- Please use the accessories provided.
- Please store this manual in a safe place.
- Please use the charger provided.
- Keep out of the hands of children and the elderly and infirm.
- If there is an overflow of inhaled liquid, please check whether the dust bucket is full, otherwise it will block the filter bag or seriously damage the vacuum cleaner.

PARTS DESCRIPTION

- 1 , On/off switch
- 2 , Charging indicator
- 3 , Dust release button
- 4 , Charging base
- 5 , Crevice nozzle
- 6 , Small brush
- 7 , adaptor

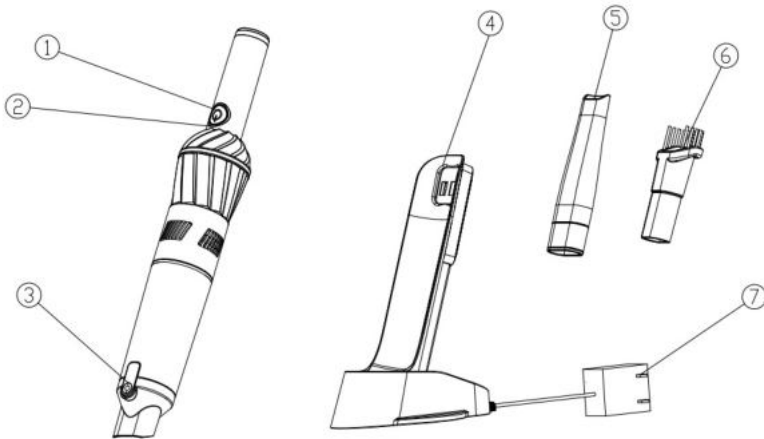

HOW TO CHARGE

Attention: the charging stand can be placed on a flat surface.

- 1 , Place the vacuum cleaner on the charging base
- 2 , Plug the charger into the socket. (make sure the machine is turned off before charging)
- 3 , When charging, the charging indicator lights is red, when it is full charged the light is blue.
- 4 , After charging, please unplug the charger.
- 5 , The charger may get hot during charging.

Important: please be sure to use the charger provided when purchasing to

charge!

CHARGING INDICATOR

- 1 , The indicator light is red color while charging
- 2 , The indicator light is blue color when full charged
- 3 , The indicator light is blue color when use the vacuum cleaner
- 4 , When the battery is running out, the red charging indicator flashes.
- 5 , When the battery is completely exhausted, the charging indicator will go off.

USE AND FUNCTION

Do not use this product while charging.

Please check whether there is rarity in the flat suction frequently. If there is a foreign body, it may scratch your floor.

- 1 , Insert crevice nozzle into main engine for cleaning table, car interior, corner, etc.

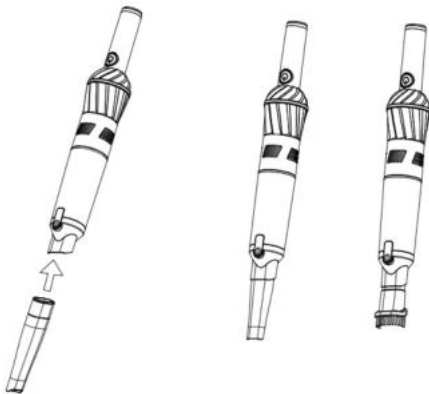



- 2 , Insert the small brush into vacuum cleaner to cleaning sofa, carpet, ect
- 3, Connect the hose and the small circular brush to the machine with the connection part
- 4 , Press the switch button to start up.
- 5, Press the switch button to turn off

Clean the dust cup

- 1, Press the lock of dust release button, take out the suction nozzle, and pour out the garbage



- 2 , Rotate the dust cup to the left and remove the dust cup.

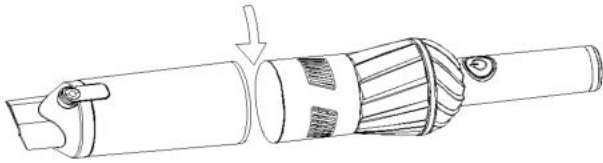

3 , Remove the filter inside.

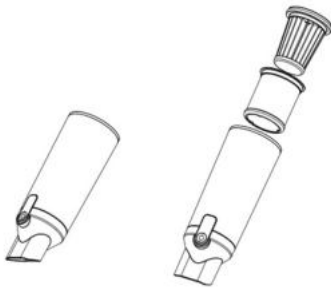

4 , Clean the filter and dust cup

5, Put the filter into dust cup

6 , Rotate the dust cup to the right dust cup into the machine.

Important: make sure the filter and dust completely dry before placing them in

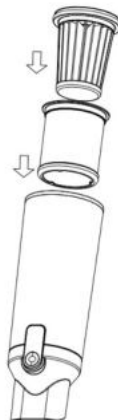

to Put the cup are place.

How to dispose of the old battery

Remove the battery from the device before discarding it.

Do not put the discarded batteries with the daily garbage

Put together; The batteries should be sent to a local authority recycling center.

If you can't remove the battery yourself,

Your local recycling center will take it down.

Maintenance

if this product fails, please be sure to have professional repair.

Disposal of old electrical appliances



The European directive 2002/96/EC on Waste Electrical and Electronic Equipment (WEEE), requires that old household electrical appliances must not be disposed of in the normal unsorted municipal waste stream. Old appliances must be collected separately in order to optimize the recovery and recycling of the materials they contain, and reduce the impact on human health and the environment.

The crossed out “wheeled bin” symbol on the product reminds you of your obligation, that when you dispose of the appliance, it must be separately collected.

Consumers should contact their local authority or retailer for information concerning the correct disposal of their old appliance.

LIMITED WARRANTY

Limited Warranty applies to purchases made from authorized retailers of **TurboTronic®**.

TurboTronic® Warranty coverage applies to the original owner and to the original product only and is not transferable.

TurboTronic® warrants that the unit shall be free from defects in material and workmanship. Limited Warranty apply only when it is used under normal household conditions and maintained according to the requirements outlined in the Owner’s Guide, subject to the following

conditions and exclusions:

What is covered by this warranty?

1. The original unit and/or non-wearable parts deemed defective, in **TurboTronic®** sole discretion, will be repaired or replaced
2. **TurboTronic®** reserves the right to replace the unit with one of equal or greater value.

What is not covered by this warranty?

1. Normal wear and tear of wearable parts (such as blending vessels, lids, cups, blades, blender bases, removable pots, racks, pans, etc.), which require regular maintenance and/or replacement to ensure the proper functioning of your unit, are not covered by this warranty.
2. Any unit that has been tampered with or used for commercial purposes.
3. Damage caused by misuse, abuse, negligent handling, failure to perform required maintenance (e.g., failure to keep the well of the motor base clear of food spills and other debris), or damage due to mishandling in transit.
4. Consequential and incidental damages.
5. Defects caused by repair persons not authorized by **TurboTronic®**. These defects include damages caused in the process of shipping, altering, or repairing the **TurboTronic®** product (or any of its parts) when the repair is performed by a repair person not authorized by **TurboTronic®**.
6. Products purchased, used, or operated outside Europe.

Illustrations may differ from actual product.

We are constantly striving to improve our products, therefore the specifications contained herein are subject to change without notice.

TurboTronic® and **Z-Line®** are registered trademarks of **Z-GLOBAL B.V.B.A®**.

PRINTED IN PRC